

RANCHO LAKE, LLC  
19955 GRANGE ROAD  
MIDDLETOWN, CA 95461  
APNs: 014-290-08 AND  
014-300-02, 03, & 04

LEGEND:

- 1530— CONTOUR ELEVATION
- — — FENCE
- ASPHALT
- GRAVEL
- CREEK / SWALE
- APN ASSESSOR'S PARCEL NUMBER
- APPROX APPROXIMATELY
- DWY DRIVEWAY
- (E) EXISTING
- (P) PROPOSED
- RD ROAD
- SF SQUARE FEET

NOTES:

1. CONTOUR INTERVAL IS 20'

- (E) GROUNDWATER WELL  
LAT: 38.77970°  
LONG: -122.53429°  
BENEFICIAL USES: DOMESTIC & FIRE PROTECTION
- (B) GROUNDWATER WELL  
LAT: 38.77697°  
LONG: -122.52711°  
BENEFICIAL USES: IRRIGATION
- (C) (E) RESIDENCE
- (D) (E) ACCESSORY AG STRUCTURE(S)
- (E) (E) BARN(S)

EXISTING CONDITIONS  
SITE PLAN

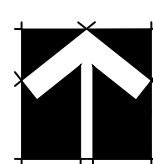
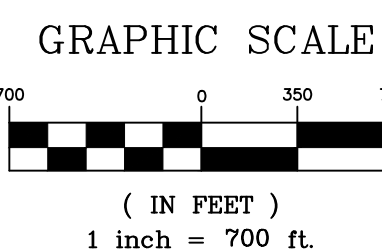

Revisions:

---  
---  
---

**REALM ENGINEERING**  
CIVIL ENGINEERING, SURVEYING & PLANNING  
1767 MARKET STREET SUITE C  
REDDING, CA. 96001  
530-526-7493

PLANS PREPARED UNDER THE SUPERVISION OF:

REGISTERED PROFESSIONAL ENGINEER  
JASON B. VIBE  
No. 67800  
Exp 06/30/25  
CIVIL  
STATE OF CALIFORNIA

EXISTING CONDITIONS SITE PLAN  
RANCHO LAKE, LLC

19955 GRANGE RD.  
MIDDLETOWN, CA 95461  
APNs: 014-290-08 & 12 AND 014-300-02, 03, & 04

PLOTTED BY:  
---  
DATE PLOTTED:  
---  
SCALE OF DRAWING:  
SEE PLAN  
JOB NUMBER:  
---  
CADD FILE:  
---  
SHEET:  
1



INTERMITTENT CLASS II WATERCOURSE W/100' SETBACK

CULTIVATION SITE PLAN WITH CANOPY

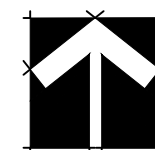

GRAPHIC SCALE

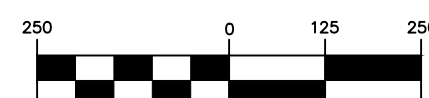

( IN FEET )  
1 inch = 250 ft.

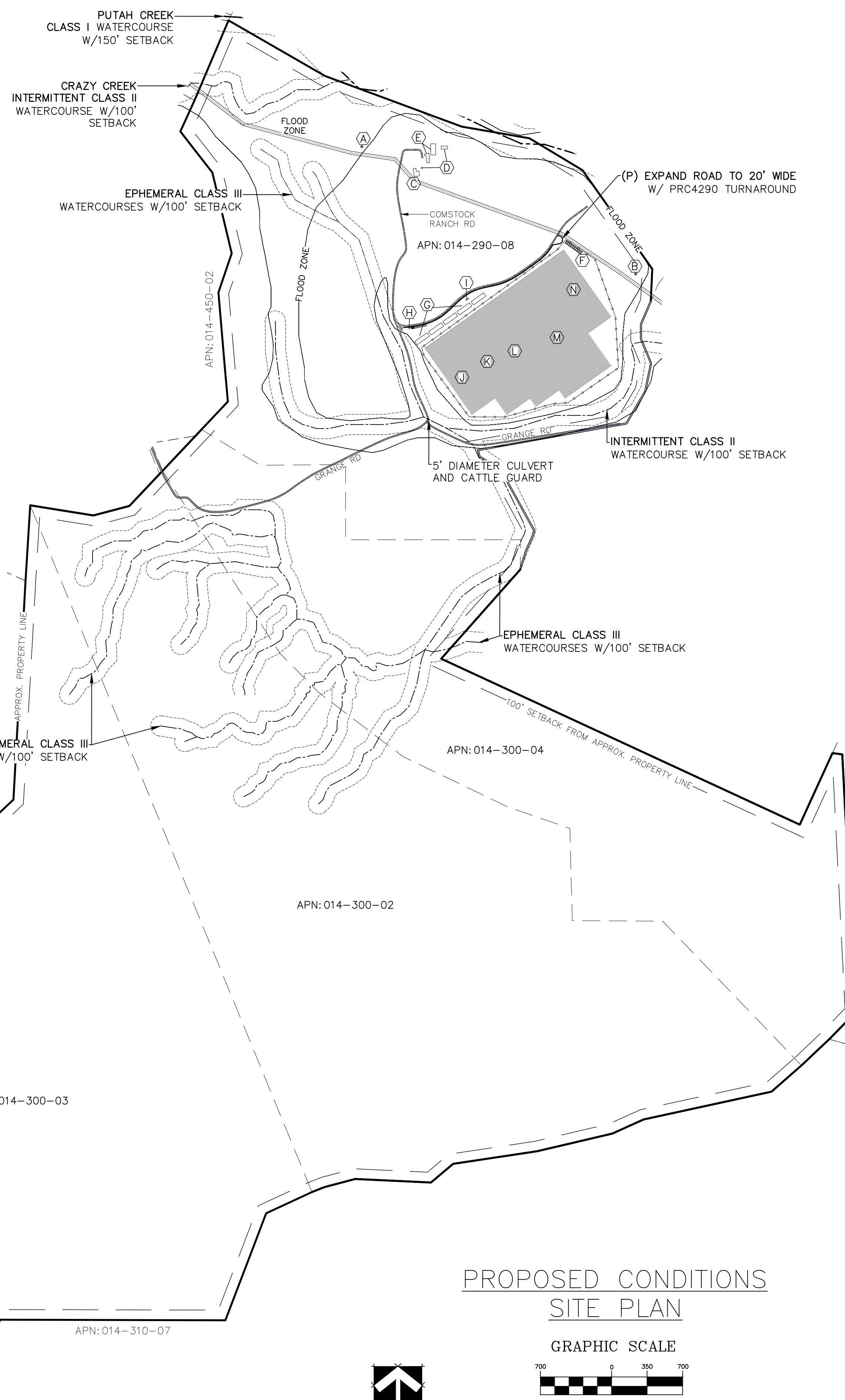

PROPOSED CONDITIONS SITE PLAN

GRAPHIC SCALE

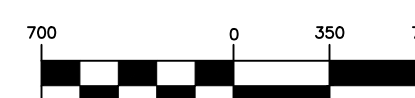

( IN FEET )  
1 inch = 700 ft.

VICINITY MAP  
NO SCALE

RANCHO LAKE, LLC  
19955 GRANGE ROAD  
MIDDLETOWN, CA 95461  
APNs: 014-290-08 AND  
014-300-02, 03, & 04

LEGEND:

- 1530- CONTOUR ELEVATION
- (P) FENCE
- ASPHALT
- GRAVEL
- CREEK / SWALE
- APN ASSESSOR'S PARCEL NUMBER
- APPROX APPROXIMATELY
- DWY DRIVEWAY
- (E) EXISTING
- (P) PROPOSED
- RD ROAD
- SF SQUARE FEET

NOTES:

1. CONTOUR INTERVAL IS 20'
- (E) GROUNDWATER WELL  
LAT: 38.77970°  
LONG: -122.53429°  
BENEFICIAL USES: DOMESTIC & FIRE PROTECTION
- (B) GROUNDWATER WELL  
LAT: 38.77897°  
LONG: -122.52711°  
BENEFICIAL USES: IRRIGATION
- (C) (E) RESIDENCE
- (D) (E) ACCESSORY AG STRUCTURE(S)
- (E) (E) BARN(S)
- (F) (E) TWENTY 5,000 GALLON HEAVY-DUTY WATER STORAGE TANKS
- (G) (E) FOUR 40'x50' (6000SF) HARVEST STORAGE AND STAGING AREAS
- (H) (E) 10'x12' (120SF) SECURITY CENTER/SHED
- (I) (E) 8'x20' (160SF) PESTICIDES & AGRICULTURAL CHEMICALS STORAGE AREA
- (J) (P) TWENTY 7'x800' (5,600SF) OUTDOOR CANOPY ROWS
- (K) (P) TWENTY 7'x1,000' (7,000SF) OUTDOOR CANOPY ROWS
- (L) (P) TWENTY 7'x1,100' (7,700SF) OUTDOOR CANOPY ROWS
- (M) (P) FOURTY 7'x1,200' (8,400SF) OUTDOOR CANOPY ROWS
- (N) (P) TWENTY 7'x806' (5,462SF) OUTDOOR CANOPY ROWS

Revisions:

**REALM ENGINEERING**  
CIVIL ENGINEERING, SURVEYING & PLANNING  
1767 MARKET STREET SUITE C  
REDDING, CA. 96001  
530-526-7493

PLANS PREPARED UNDER THE SUPERVISION OF:  
REGISTERED PROFESSIONAL ENGINEER  
JASON B. VINE  
No. 67800  
Exp 06/30/25  
CIVIL  
STATE OF CALIFORNIA

**PROPOSED CONDITIONS SITE PLAN**  
RANCHO LAKE, LLC  
19955 GRANGE RD.  
MIDDLETOWN, CA 95461  
APNs: 014-290-08 & 12 AND 014-300-02, 03, & 04

PLOTTED BY: ---  
DATE PLOTTED: ---  
SCALE OF DRAWING: SEE PLAN  
JOB NUMBER: ---  
CADD FILE: ---  
SHEET: 2

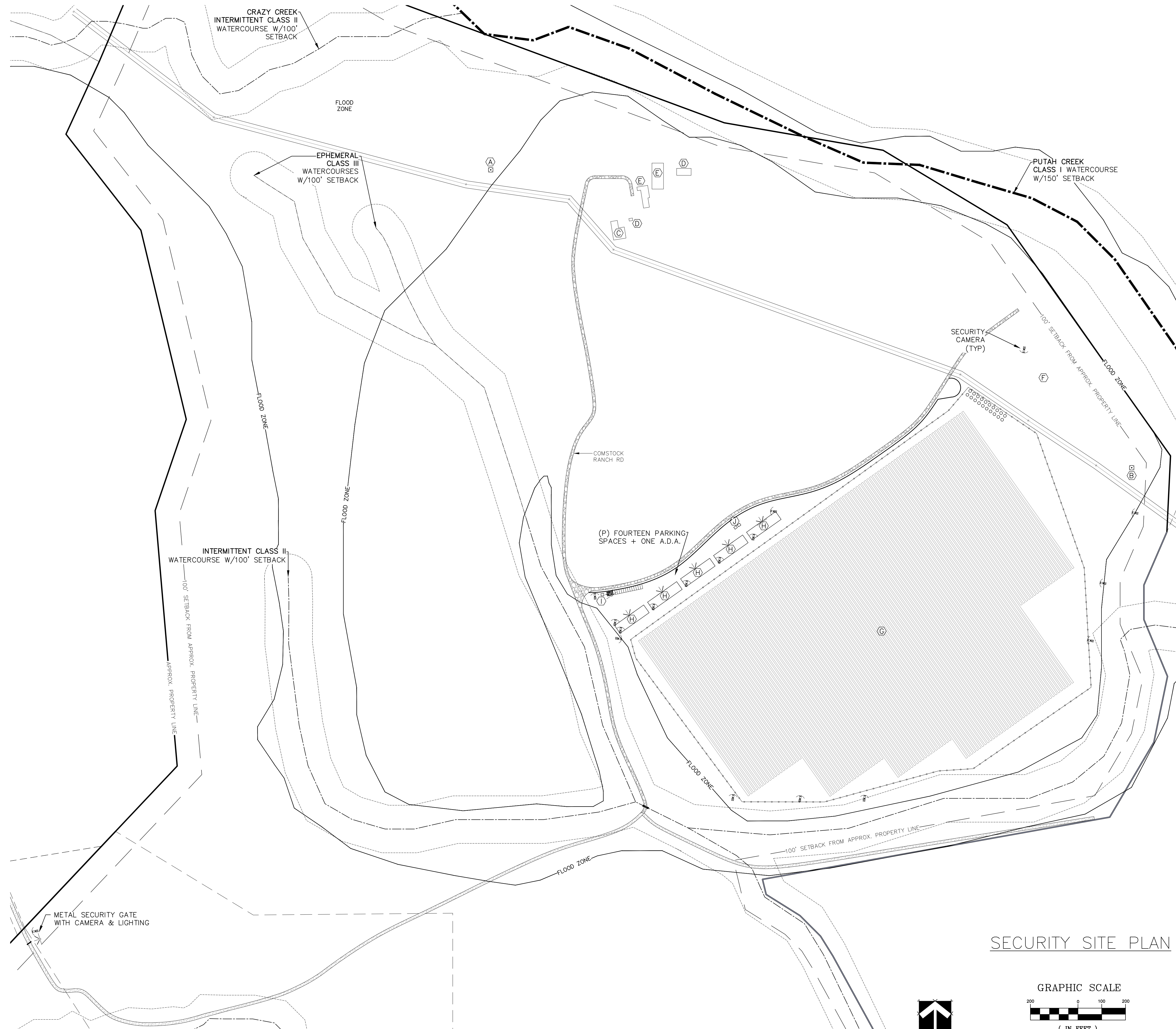

VICINITY MAP  
NO SCALE

RANCHO LAKE, LLC  
19955 GRANGE ROAD  
MIDDLETOWN, CA 95461  
APNs: 014-290-08 AND  
014-300-02, 03, & 04

- LEGEND:**
- 1530— CONTOUR ELEVATION
  - (P) FENCE
  - ✱ (P) SECURITY LIGHTS
  - 📷 (P) SECURITY CAMERAS
  - APN ASSESSOR'S PARCEL NUMBER
  - APPROX APPROXIMATE
  - DWY DRIVEWAY
  - (E) EXISTING
  - (P) PROPOSED
  - RD ROAD
  - SF SQUARE FEET

- NOTES:**
1. CONTOUR INTERVAL IS 20'
- (E) GROUNDWATER WELL  
LAT: 38.77970°  
LONG: -122.53429°  
BENEFICIAL USES: DOMESTIC & FIRE PROTECTION
  - (A) (E) GROUNDWATER WELL  
LAT: 38.77897°  
LONG: -122.52711°  
BENEFICIAL USES: IRRIGATION
  - (B) (E) RESIDENCE
  - (C) (E) ACCESSORY AG STRUCTURE(S)
  - (D) (E) BARN(S)
  - (E) TWENTY 5,000 GALLON HEAVY-DUTY WATER STORAGE TANKS
  - (F) (P) OUTDOOR CULTIVATION AREA
  - (G) (E) FIVE 40'x50' (6000SF) HARVEST STORAGE AND STAGING AREAS
  - (H) (E) 10'x12' (120SF) SECURITY CENTER/SHED
  - (I) (E) TWO 10'x12' (120SF) PESTICIDES & AGRICULTURAL CHEMICALS STORAGE AREA
  - (J)

SECURITY SITE PLAN

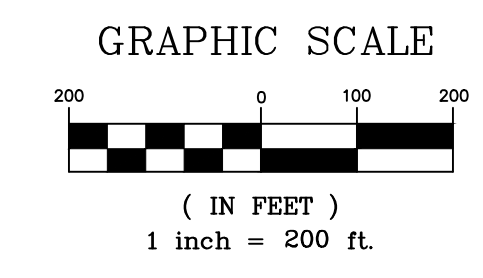
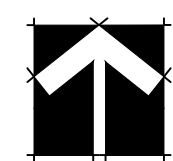

Revisions:

**REALM ENGINEERING**  
CIVIL ENGINEERING, SURVEYING & PLANNING  
1767 MARKET STREET SUITE C  
REDDING, CA. 96001  
530-526-7493

PLANS PREPARED UNDER THE SUPERVISION OF:

REGISTERED PROFESSIONAL ENGINEER  
JASON B. VILE  
No. 67800  
Exp. 06/30/25  
CIVIL  
STATE OF CALIFORNIA

SECURITY SITE PLAN  
RANCHO LAKE, LLC

19955 GRANGE RD.  
MIDDLETOWN, CA 95461  
APNs: 014-290-08 & 12 AND 014-300-02, 03, & 04

PLOTTED BY: \_\_\_\_\_  
DATE PLOTTED: \_\_\_\_\_  
SCALE OF DRAWING: SEE PLAN  
JOB NUMBER: \_\_\_\_\_  
CADD FILE: \_\_\_\_\_  
SHEET: \_\_\_\_\_

**3**



**NOTES:**

1. STRAW ROLL INSTALLATION REQUIRES THE PLACEMENT AND SECURE STAKING OF THE ROLL IN A TRENCH, 3"-5" (75-125mm) DEEP, DUG ON CONTOUR. RUNOFF MUST NOT BE ALLOWED TO RUN UNDER OR AROUND ROLL.
2. STRAW ROLLS MUST BE PLACED ALONG SLOPE CONTOURS

**EROSION & SEDIMENT CONTROL NOTES:**

1. CONTRACTOR IS TO IMPLEMENT BEST MANAGEMENT PRACTICES (BMPs) TO CONTROL EROSION CONTROL AND REDUCE THE OFF-SITE DISCHARGE OF SEDIMENT TO THE MAXIMUM EXTENT PRACTICABLE.
2. EROSION CONTROL BMPs SHALL BE IN PLACE AND MAINTAINED ALL YEAR ROUND.
3. THE CONTRACTOR SHALL FOLLOW THE GUIDELINES FROM THE "CALIFORNIA STORMWATER BMP HANDBOOK" FOR THE MEASURES SHOWN OR STATED ON THESE PLANS.
4. CONTRACTOR MUST ENSURE THAT THE CONSTRUCTION SITE IS PREPARED PRIOR TO THE ONSET OF ANY STORM.
5. ALL EROSION AND SEDIMENT CONTROL MEASURES SHALL BE CHECKED BEFORE AND AFTER ALL STORMS TO ENSURE MEASURES ARE FUNCTIONING PROPERLY.
6. THIS PLAN MAY NOT COVER ALL THE SITUATIONS THAT ARISE DURING CONSTRUCTION DUE TO ANTICIPATED FIELD CONDITIONS. VARIATIONS MAY BE MADE TO THE PLAN IN THE FIELD SUBJECT TO THE APPROVAL OF OR AT THE DIRECTION OF A REPRESENTATIVE OF LAKE COUNTY.
7. ALL EROSION AND SEDIMENT CONTROL MEASURES SHALL BE CHECKED BEFORE AND AFTER ALL STORMS TO ENSURE MEASURES ARE FUNCTIONING PROPERLY.
8. CONTRACTOR SHALL MAINTAIN A LOG AT THE SITE OF ALL INSPECTIONS OR MAINTENANCE OF BMPs, AS WELL AS, ANY CORRECTIVE CHANGES TO THE BMPs OR EROSION AND SEDIMENT CONTROL PLAN.
9. THE CONTRACTOR SHALL INSTALL THE STABILIZED CONSTRUCTION ENTRANCE PRIOR TO COMMENCEMENT OF GRADING. LOCATION OF THE ENTRANCE MAY BE ADJUSTED BY THE CONTRACTOR TO FACILITATE GRADING OPERATIONS. ALL CONSTRUCTION TRAFFIC ENTERING THE PAVED ROAD MUST CROSS THE STABILIZED CONSTRUCTION ENTRANCE.
10. ALL SEDIMENT DEPOSITED ON PAVED ROADWAYS SHALL BE SWEEPED AT THE END OF EACH WORKING DAY OR AS NECESSARY.
11. ANY LOOSE GROUND FROM EXCAVATING GRADING OPERATIONS SHALL BE SECURED PRIOR TO ANY RAIN EVENT. STRAW OR TARP ALL DISTURBED OR EXCAVATED GROUND.
12. CONTRACTOR SHALL PLACE GRAVEL BAGS AROUND ALL NEW DRAINAGE STRUCTURE OPENINGS IMMEDIATELY AFTER THE STRUCTURE OPENING IS CONSTRUCTED. THESE GRAVEL BAGS SHALL BE MAINTAINED AND REMAIN IN PLACE UNTIL CONSTRUCTION IS COMPLETED.
13. AS A MINIMUM, ALL GRADED AREAS AND EXPOSED SOIL WITHIN THE PROJECT SHALL BE SEEDED PER THE REQUIREMENTS OF LAKE COUNTY.
14. DUST GENERATION MUST BE MINIMIZED AND A WATER TRUCK MUST BE AVAILABLE ON-SITE FOR ADEQUATE DUST CONTROL.

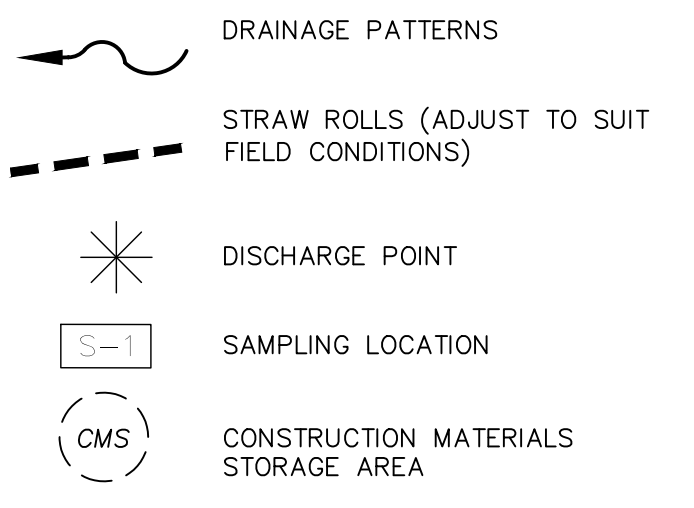

**LEGEND:**

- 1530 CONTOUR ELEVATION
- FENCE
- ASPHALT
- GRAVEL
- CREEK / SWALE
- APN ASSESSOR'S PARCEL NUMBER
- APPROX APPROXIMATELY
- DWY DRIVEWAY
- (E) EXISTING
- (P) PROPOSED
- RD ROAD
- SF SQUARE FEET

**NOTES:**

1. CONTOUR INTERVAL IS 20'
- (E) GROUNDWATER WELL  
LAT: 38.77970°  
LONG: -122.53429°  
BENEFICIAL USES: DOMESTIC & FIRE PROTECTION
  - (E) GROUNDWATER WELL  
LAT: 38.77897°  
LONG: -122.52711°  
BENEFICIAL USES: IRRIGATION
  - (E) RESIDENCE
  - (E) ACCESSORY AG STRUCTURE(S)
  - (E) BARN(S)
  - (E) TWENTY 5,000 GALLON HEAVY-DUTY WATER STORAGE TANKS
  - (P) OUTDOOR CULTIVATION AREA
  - (E) FIVE 40'x50' (6000SF) HARVEST STORAGE AND STAGING AREAS
  - (E) 10'x12' (120SF) SECURITY CENTER/SHED
  - (E) TWO 10'x12' (120SF) PESTICIDES & AGRICULTURAL CHEMICALS STORAGE AREA

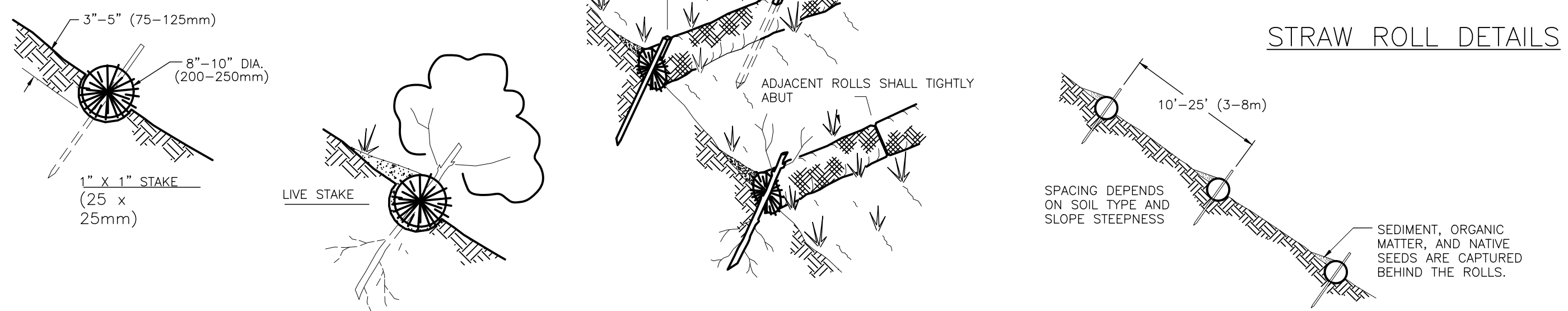

**EROSION & SEDIMENT CONTROL PLAN**

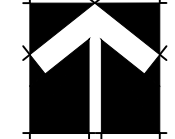
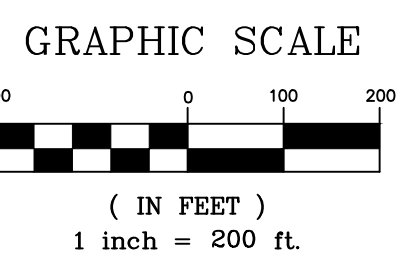

Revisions:

**REALM ENGINEERING**  
CIVIL ENGINEERING, SURVEYING & PLANNING  
1767 MARKET STREET SUITE C  
REDDING, CA. 96001  
530-526-7493

PLANS PREPARED UNDER THE SUPERVISION OF:  
  
 REGISTERED PROFESSIONAL ENGINEER  
 JASON B. VANE  
 No. 67800  
 Exp 06/30/25  
 CIVIL  
 STATE OF CALIFORNIA

**EROSION & SEDIMENT CONTROL PLAN**  
RANCHO LAKE, LLC

19855 GRANGE RD.  
MIDDLETOWN, CA 95461  
APNS 014-300-02, 03, & 04

PLOTTED BY: \_\_\_\_\_  
DATE PLOTTED: \_\_\_\_\_  
SCALE OF DRAWING: SEE PLAN  
JOB NUMBER: \_\_\_\_\_  
CADD FILE: \_\_\_\_\_  
SHEET: \_\_\_\_\_

**4**