

October 28, 2025
Cobb Park, Lake County
Lake County
R&C PN 24056

0' 100' 200'
1" = 100'



Cobb Park
Preliminary Plan

L1

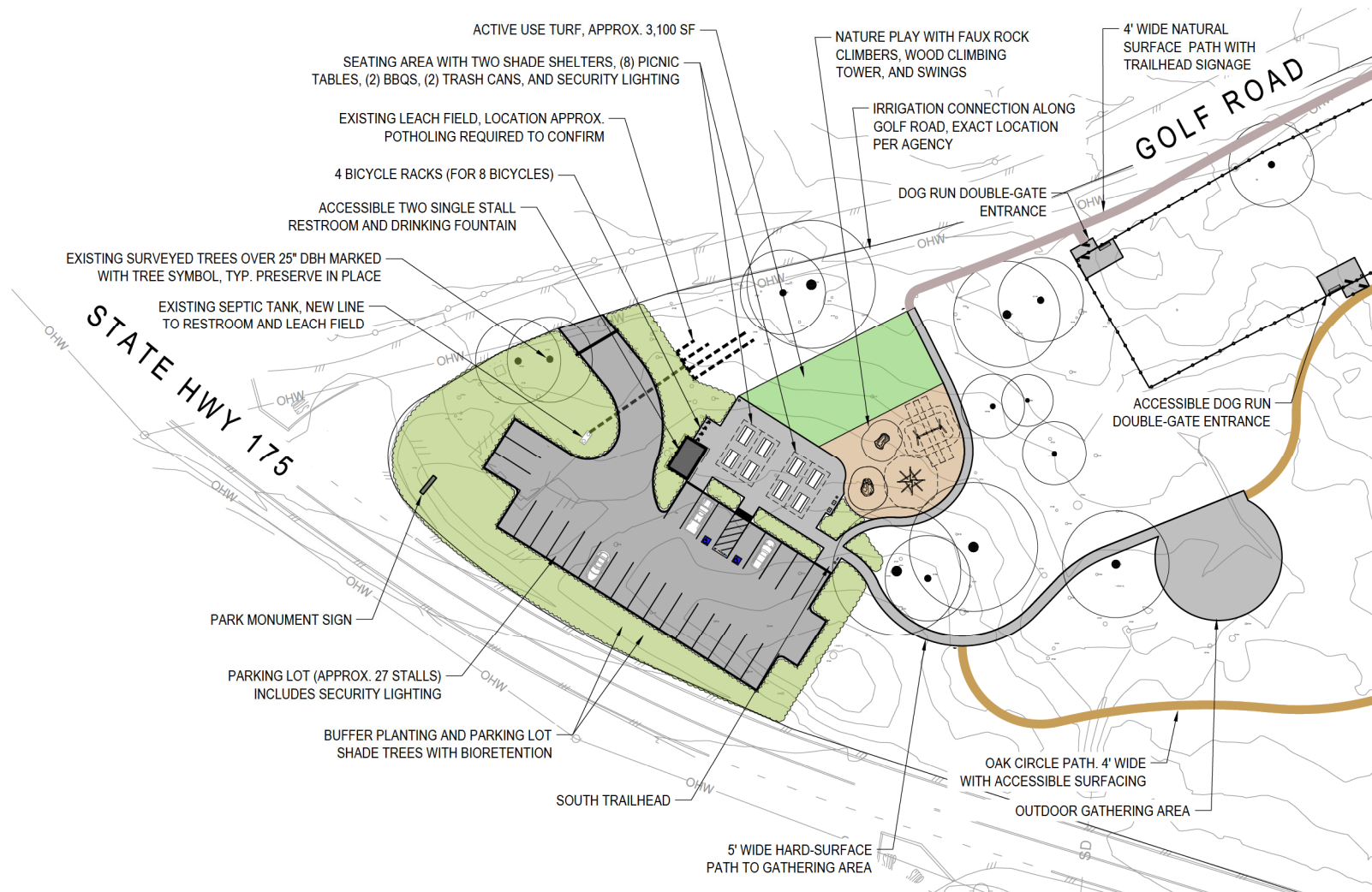

October 26, 2025
Cobb Park, Lake County
Lake County
R&C PN: 24056

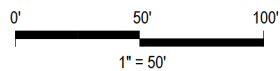

Cobb Park
Primary Recreation Area Enlargement

L2

PHASING LEGEND

- PHASE 1 - INCLUDES PREPARATION WORK, KEY PARK AMENITIES, AND BASIC SUPPORT AMENITIES
- PHASE 2 - TRAIL AND ASSOCIATED IMPROVEMENTS NORTH OF CREEK AND ASSOCIATED WITH TRAIL
- CREEK RESTORATION AND RIVER ACCESS
- FAR FUTURE PHASE

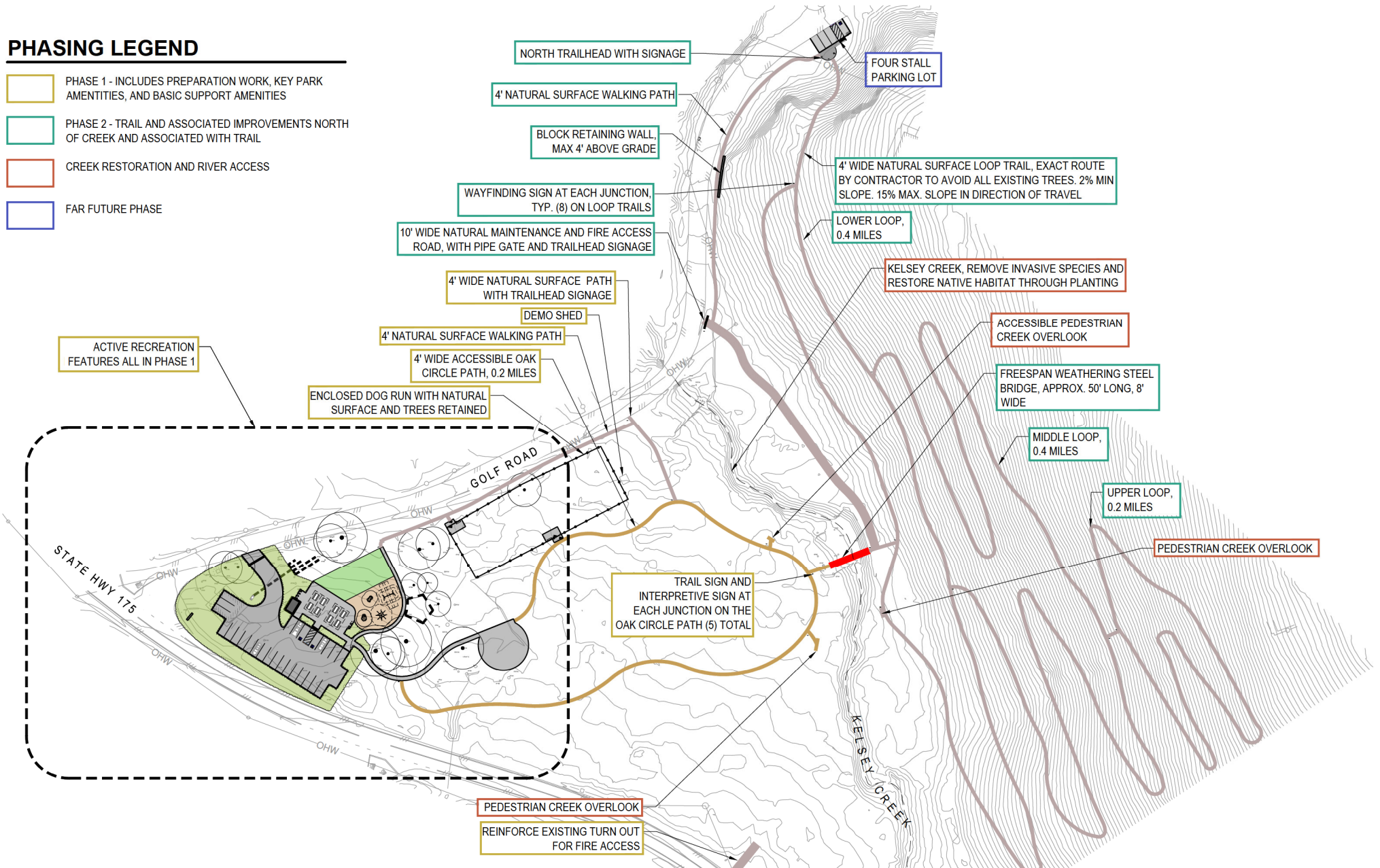

April 8, 2025
Cobb Park, Lake County
Lake County
R&C PN 24056

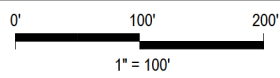

Cobb Park
Phasing Exhibit **PH1**