

EXHIBIT A

COUNTY OF LAKE



**LIMIT OF AGREEMENT
ROUTE 29 PM 31.6**

**STATE OF CALIFORNIA
DEPARTMENT OF TRANSPORTATION
MAP SHOWING**

01-LAK-29 PM 28.5/31.6

**CONTROLLED ACCESS HIGHWAY
IN THE COUNTY OF LAKE**

**ON ROUTE 29
FROM 0.6 MILE NORTH OF JUNCTION 29/281
TO 0.6 MILE NORTH OF JUNCTION 29/175**

COUNTY OF LAKE

LIMIT OF AGREEMENT
ROUTE 29 PM 28.5

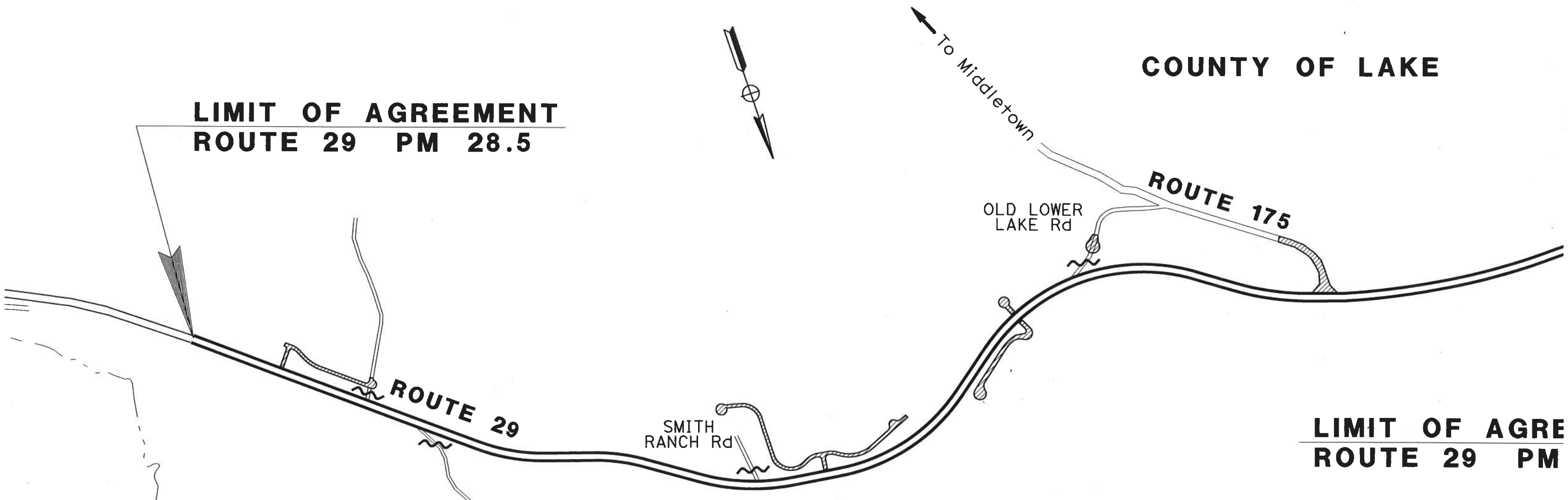



LIMIT OF AGREEMENT
ROUTE 29 PM

SCALE IN FEET

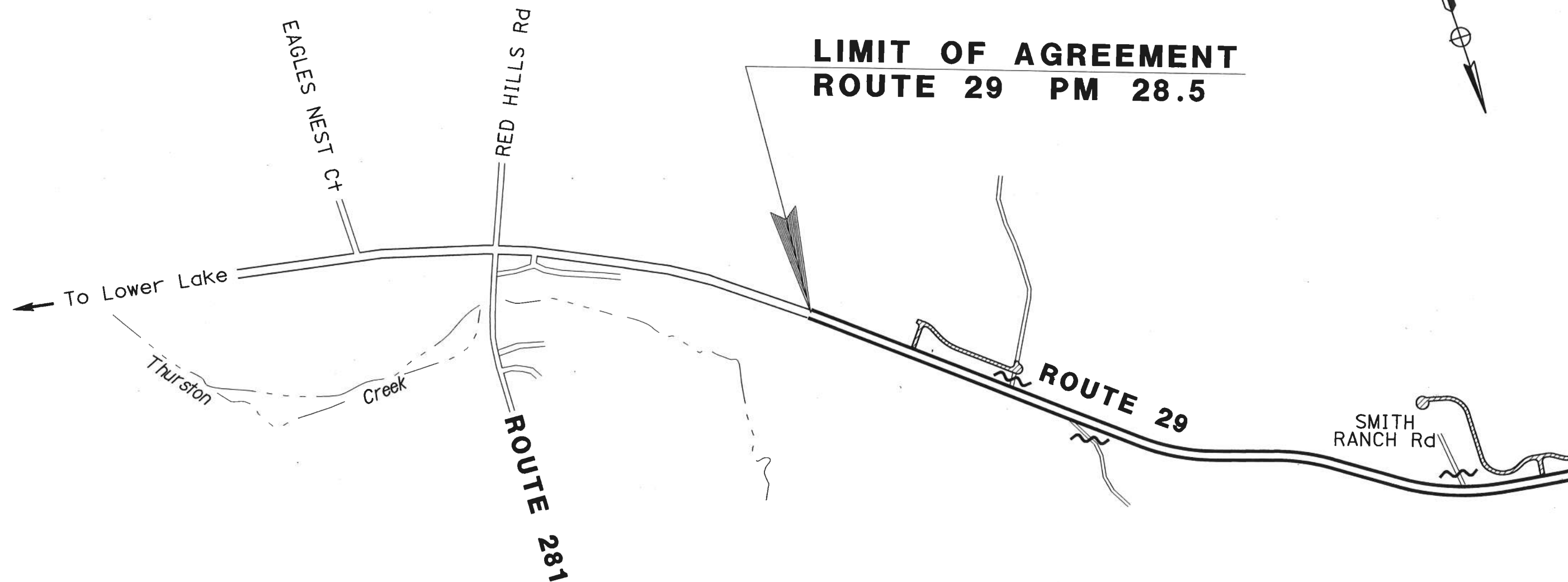



LEGEND

-  CONTROLLED ACCESS HIGHWAY AND CONNECTIONS
-  ROAD CLOSURE AND TERMINUS CONSTRUCTION AS NECESSARY
-  ROAD TO BE CONSTRUCTED, RECONSTRUCTED, OR RELOCATED

