

BOARD OF SUPERVISORS, COUNTY OF LAKE, STATE OF CALIFORNIA

RESOLUTION NO. 2020-05

RESOLUTION DECLARING COUNTY PROPERTY SURPLUS AND AUTHORIZING THE
SALE OF A PORTION OF THE PROPERTY TO THE LAKE COUNTY TRANSIT
AUTHORITY

WHEREAS, the County of Lake (hereinafter, the County) presently owns a parcel of real property within the city limits of Clearlake which is unused by the County and vacant, which the County is presently in the process of subdividing to then allow a portion of said property to be conveyed to the Lake County Transit Authority; and

WHEREAS, the above-described portion of real property is more particularly described in Exhibit A attached hereto and incorporated herein by reference (hereinafter, the "Property"); and

WHEREAS, the Lake County Transit Authority is an independent special district that wishes to make use of said Property as a transit hub, providing greater access to commercial and residential development, commercial, medical, and governmental services, and facilities throughout the County to those with limited or no means of alternate transportation; and

WHEREAS, upon completion of the subdivision action and the issuance of a new Assessor's Parcel Number for the Property, the County of Lake is willing to sell the Property to the Lake County Transit Authority as authorized by Government Code section 25365 and wishes to initiate negotiations to achieve that purpose; and

WHEREAS, the County has complied with the California Environmental Quality Act (CEQA) by finding that the disposition of this Property is exempt from further environmental review in accordance with Class 12 Section 15312.

NOW THEREFORE, BE IT RESOLVED that the Board of Supervisors of the County of Lake hereby finds and declares as follows:

1. That the recitals set forth hereinabove are true and correct.
2. That the parcel of real property described hereinabove is no longer necessary for the uses and purposes of the County and is thereby declared to be surplus real property.
3. That the legal subdivision of said parcel shall be completed, culminating with the issuance of an Assessor's Parcel Number for the portion thereof which is identified herein as the Property and more particularly described in Exhibit "A" hereto.
4. That said Property shall be the subject of a negotiated sale by the County to the Lake County Transit Authority in accordance with Government Code section 25365.
5. That the Board shall designate a negotiating team to which it shall delegate the authority to negotiate this sale on behalf of the County of Lake.
6. That said delegates shall present the purchase agreement tentatively reached for consideration and approval by this Board in the course of a regularly scheduled and open meeting.

//

//

//

//

//

THIS RESOLUTION WAS PASSED AND ADOPTED by the Board of Supervisors of the County of Lake, State of California, at a regular meeting thereof on 01/14, 2020 by the following vote:

AYES Supervisors Sabatier, Crandell, Brown, Scott, and Simon

NOES: None

ABSENT OR NOT VOTING: None



CHAIR, Board of Supervisors

ATTEST: CAROL J. HUCHINGSON
Clerk of the
Board of Supervisors

APPROVED AS TO FORM:

ANITA L. GRANT
County Counsel

By: 

By: 



EXHIBIT “A”

EXHIBIT 'A'
LEGAL DESCRIPTION

Lying within the City of Clearlake, County of Lake, State of California and being a portion of the parcel of land described in the deed to the County of Lake, recorded November 9, 1956 in Book 270 at Page 134, Official Records of Lake County, more particularly described as follows:

COMMENCING at the northeast corner of Parcel 1 as shown on the Parcel Map recorded September 15, 1987 in Book 29 of Parcel Maps at Pages 35 & 36, Lake County Records, thence along the northerly line of said Parcel 1 North 89°52'18" West (shown as South 89°50'01" East on said Parcel Map) 50.02 feet to the POINT OF BEGINNING; thence continuing along said northerly line of Parcel 1 and along the northerly line of Parcel A as shown on the Parcel Map recorded May 29, 1973 in Book 6 of Parcel Maps at Page 26, Lake County Records and along its westerly prolongation, North 89°52'18" West 511.41 feet to the easterly line of Parcel One described in the deed to the State of California, recorded March 31, 1995 as Document Number 95-004591 in the Office of the Lake County Recorder; thence along said easterly line, North 23°03'17" West (shown as South 22°38'14" East in said deed) 120.39 feet to the southerly line of the parcel of land described in the deed to Clear Lake Masonic Building Association, recorded February 24, 1964 in Book 421 at Page 129, Official Records of Lake County; thence along said southerly line, South 89°50'01" East 380.83 feet to the southeasterly corner of said parcel; thence North 19°59'19" West 299.79 feet (shown as South 19°33'00" East 300.00 feet in said deed) to the northeasterly corner of said parcel; thence South 89°50'01" East 265.86 feet; thence along a curve to the right, having a radius of 25.00 feet, through a central angle of 91°29'15" for a length of 39.92 feet to a point that is 50.00 feet westerly from and measured at a right angle to the westerly line of the parcel of land described in the deed to the Konocti Unified School District, recorded September 26, 1966 in Book 504 at Page 472, Official Records of Lake County; thence along a line that is 50.00 feet distant westerly and parallel with said westerly line, South 1°39'14" West 366.20 feet to the POINT OF BEGINNING.

Containing 2.88 acres, more or less.

BASIS OF BEARINGS

Being North 1°39'52" East between found 5/8" rebar monuments as shown on the Record of Survey filed in Book 91 of Surveys at Page 45, Lake County Records.

Portion of APN 010-043-52

Prepared by Cinquini & Passarino, Inc.

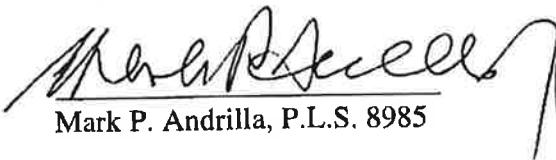
Mark P. Andrilla, P.L.S. 8985

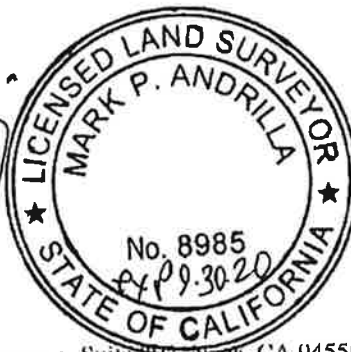

11.19.19
Date

1804 Soscol Avenue, Suite 202, Napa, CA 94559
Tel: (707) 690-9025 Fax: (707) 542-2106
www.cinquinipassarino.com
CPI No.: 8632-19